

A TWO PART FLEXIBLE CEMENTITIOUS WATERPROOFING MEMBRANE FOR CONCRETE & MORTAR SURFACES

DESCRIPTION

A two part acrylic polymer modified flexible cementitious waterproof coating supplied in kits ready to use for the protection of concrete and mortar. Contite WS2 provides excellent adhesion, flexibility, and durability.

USES & ADVANTAGES

Contite WS2 is suitable for many waterproofing applications including for sealing swimming pools, balconies, bathrooms, wet areas, tanks and basements.

Advantages include:

- Minor / micro crack bridging & sealing.
- Non toxic.
- Excellent adhesion.
- Protection against carbonation and chlorides.
- Unlike conventional coatings that require the concrete to cure for 7 - 28 days it can be applied to 24 hours old concrete.
- Excellent elongation and flexibility.
- Increased frost & salt resistance.
- Easy to apply.
- Minimum surface preparation needed.
- Excellent for damp-proofing basements below ground.
- Breathable - allows transmission of water vapour from interior of building.

PROPERTIES AND COMPLIANCES

Component:	Two (Part A - Polymer / Part B - Powder)
Appearance:	Grey (when mixed)
Mixed Density:	2.00 ± 0.05 kg/l.
Pot life:	30 minutes at 30°C. Pot life will be shortened at higher temperatures
Elongation:	> 40% (unbonded) ASTM D412
Compressive Strength:	23-25 N/mm ² ASTM C109
Tensile Strength:	> 1.5 N/mm ² ASTM D412
Flexural Strength:	10-12 N/mm ² ASTM C-348
Abrasion Resistance:	1.0-1.3% weight loss ASTM C-241
Adhesion to Concrete:	1.5 N/mm ² ASTM D4541
Water Absorption:	<2% ASTM D870
Water Permeability:	> 85% improvement over control BS 12390-Part 8
Toxicity:	Non toxic BS 6920-Part 1
Crack Bridge Ability:	No crack at 1.3 mm width ASTM C836
Mixing Ratio:	A : B = 1 : 4 by weight
Coverage:	Approx. 0.9 kg/m ² /coat at 0.5 mm thickness, apply 2 coats
Application Temperature:	+5°C to +40°C

* Properties are typical under laboratory conditions and do not constitute a specification. Field trials are recommended.

MIXING

Contite WS2 is supplied in premeasured units. Slowly add the powder to the liquid and mix to a lump free smooth consistency. Do not add water or rework a stiffened mix by adding water. Mix sufficient material to use within 30-40 minutes.

SUBSTRATE PREPARATION

The substrate should be clean and sound, free of dust loose particles, grease, oil, primers from previous membrane systems or bitumen. Bitumen or primers should be removed by shotblasting or mechanical means, alternatively seal with a Cormix Sealer. Bond tests should be undertaken if the surface is already saturated with bitumen or bitumen primers. Spalled concrete should be repaired by cutting out to sound concrete and patching with Conpatch 600 (consult Cormix International Technical Department).

APPLICATION

Saturate the concrete's surface with clean water. Apply the first coat while the surface is still damp but no free standing water. Apply using a short stiff bristle brush or roller at a minimum of 0.5-1.0 mm per coat. Leave to dry for 2-6 hours. The second coat can be rubbed down with a soft dry sponge. Spray or trowel application is acceptable providing the mixing ratio is adjusted to achieve the right consistency.

PRECAUTIONS

Pull off tests should be undertaken with non standard surfaces and to check bond of tile adhesive to Contite WS2. On hot surfaces e.g. above 40°C surface temperature a primer coat of mixed Contite WS2 and water with a slurry consistency should be applied. Consideration to saturating the surface in advance and protection from adverse wind & sun conditions must be given in exposed areas. The Contite WS2 must be applied over the primer coat before it dries. For light foot traffic areas the coating should be at least 2 mm thick. For advice contact Cormix Technical Service Department.

DETAILING

Wall to Floor Joint Detail - Blocks, Bricks or Concrete

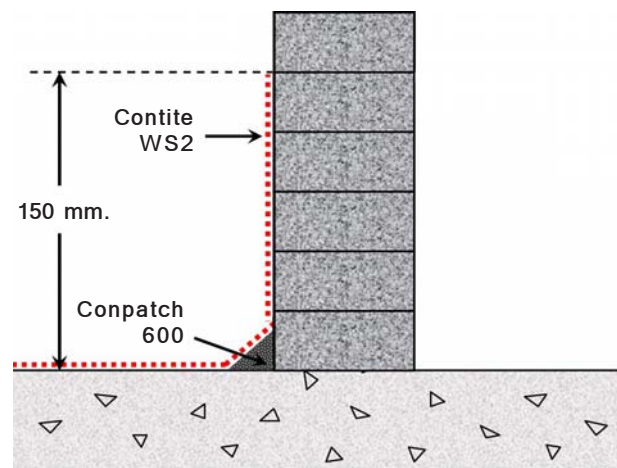

A TWO PART FLEXIBLE CEMENTITIOUS WATERPROOFING MEMBRANE FOR CONCRETE & MORTAR SURFACES

Construction/Cold Joint & Pipe Penetration Detail

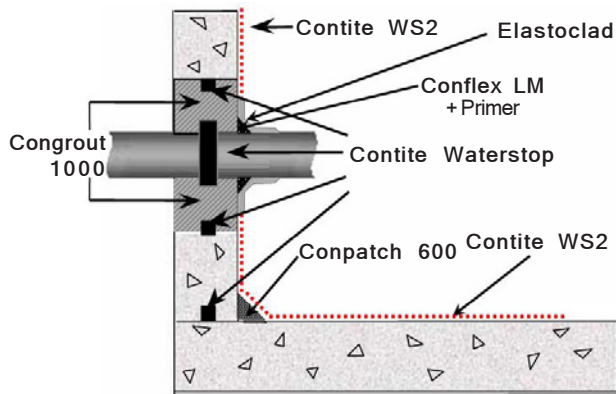

Drain Detail

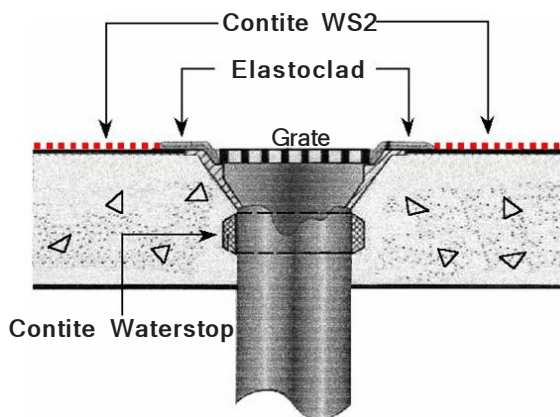

Penetration Detail

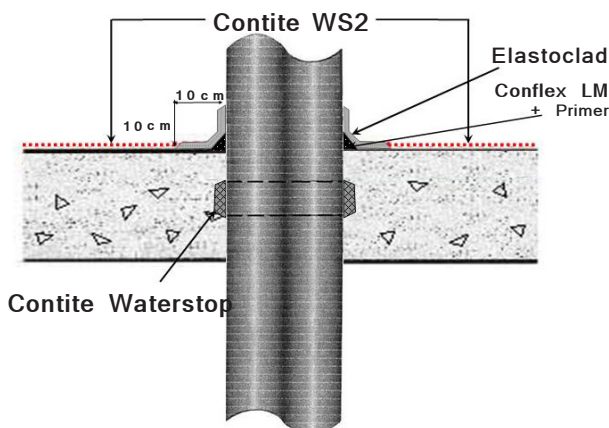

CURING

Contite WS2 should be protected from high wind & intense sunshine. Keep moist for 3 - 4 days after application. Protect from rain until fully hardened.

SUBSEQUENT FINISHES

Contite WS2 is compatible with most forms of subsequent coatings.

COVERAGE RATES

6 m²/set of 25 kg at 2 mm. thickness in 2-3 coats. Actual coverage depends upon porosity & texture of the substrate.

CLEANING

Clean tools with water before material hardens.

PACKAGING

25 kgs set.
Part A liquid 5 kg plastic pails; Part B powder 20 kg bags.

STORAGE & SHELF LIFE

In excess of 9 months if unopened, stored free from frost, moisture and direct sunlight.

HEALTH & SAFETY

Contite WS2 is non-toxic but is alkaline in its nature. When applying gloves & goggles should be worn. Wash off splashes to skin with water. If in eyes wash out with plenty of clean water and seek medical attention. Contite WS2 is non-flammable.

TECHNICAL SERVICE

The Cormix International Technical Service Department is available to assist you in the correct use of our products and its resources are at your disposal entirely without obligation.

QUALITY ASSURANCE

ISO 9001 : 2008 verified by TUV Nord.



1012

Cormix International Limited
89 Romklao Rd., Sansab,
Minburi Bangkok 10510
09

1012-CPD-0102

EN 1504-2

Protection and repair
of concrete structures :
Surface protection systems
for concrete coating
(PI, MC,IR)

Permeability to CO₂: $s_D > 50$ m

Permeability to water

vapour:

$s_D < 5$ m

Capillary absorption and

permeability to water: < 0.1 kg/

$m^2 \cdot h^{0.5}$

Pull-off test: ≥ 0.8 N/mm²

Dangerous substances: Comply

with 5.3

Reaction to fire: Class E

CONTACT DETAILS

Cormix International Limited

Regional Office,

89 Romklao Rd., Sansab, Minburi, Bangkok 10510

Tel. (66 2) 917 3955-8, 543 8890

Fax. (66 2) 917 3959, 543 8891

<http://www.cormix.com> E-mail : info@cormix.com

NOTE : Every reasonable precaution is taken in the manufacture of all CORMIX-products to ensure that they comply with CORMIX's high standard of quality. The recommendations and properties of the product are based upon what is believed to be the most reliable information available, and are not intended as recommendations which infringe on other patents. Although all CORMIX-products are subject to rigid quality tests, no specific guarantee can be given, because results depend, not only on quality, but also on other factors beyond our control. We welcome therefore consultation in the event of doubt concerning application, or performance, and point out that oral recommendations, which vary from the instructions contained herein, are not binding without written confirmation by CORMIX. All transactions shall be subject to our terms and conditions of sale-delivery-and-service. This data sheet supercedes the previous one and a reprint may be issued without notice to supersede this edition, as and when deemed necessary. The information given in this leaflet is to the best of our knowledge true and reliable. Field service where provided does not constitute supervisory responsibility. Our guarantee is therefore limited to the quality of materials delivered.